

**RB**  **I**



**上海容贝实业有限公司**



**RB@I**

自动化控制系统的全面解决方案

# >> 公司简介

上海容贝实业有限公司地处国家旅游区，美丽的佘山脚下，地铁九号线，沪青平公路，沪松公路，莘砖公路都在我公司两公里范围内，交通十分便利；是集设计、生产、贸易于一体的专业实体，主要从事各类电器柜，控制柜，网络柜，电控箱，冷作板金，各种货架，推车、工具箱，金属外壳，冲压件，不锈钢铝制品等金属制品的生产,并可根据客户需求进行非标制作，产品造型优美、种类繁多，广泛应用于仪表通信、自动化控制，航空航天、船舶、低压电器、公交系统、电视监控、计算机网络、医疗电子等行业；公司拥有一批年轻的高技能人才，全部采用三维设计软件制作，为客户在品质上提供最周到的服务。

本公司成立以来始终坚持"诚信为本"的原则，以"用户至上、质量第一、交货及时、价格合理"的经营理念，热诚欢迎各界朋友前来参观指导，忠心的为顾客提供高品质的产品，愿通过服务这座桥梁为双方共同的发展做出不懈的努力，在创新，卓越的道路继续前行。



## >> 设备状况

公司拥有日本天田(AMADA)50吨转塔式冲床和台励福50吨转塔式冲床各一台，100吨FBD模糊逻辑控制校正弯板机两台，数控点胶设备一台，数控剪板设备一台，普通通用钣金加工机械数十台，5吨10米跨度行车5台及电器测试设备等等。



# 目录

## TEBLE OF CONTENTS

	EB控制箱系列	1-2
	KL接线箱系列	3-4
	AE挂壁箱系列	5-6
	BAE不锈钢挂壁箱系列	7-8
	AE立式控制箱系列	9-10
	BAE不锈钢立式控制箱系列	11-12
	AK立式控制箱系列	13-14
	ES独立式控制柜系列	15-16
	BES独立式控制柜系列	17-18
	PS组合柜系列	19-20
	BPS不锈钢组合柜系列	21-22
	PC电脑柜系列	23-24
	RB工控柜系列	25-26
	PA斜面操作台系列	27-28
	PA三段式操作台系列	29-30
	机箱机柜附件系列	31-33

## EB 控制箱系列

EB control box series



材料 Material	冷轧钢板 Cold rolled steel sheet
表面处理 Surface treatment	箱体和门板磷化底涂处理, 外部为粉末涂层, 颜色可分RAL7032和RAL7035两种织纹, 安装板则为镀锌 Etch primer for box body and door plate; powder coating for outside; RAL7032 or RAL7035 texture optional; galvanized mounting plate
防护等级 Protection grade	IP56(按GB4205-1993) IP56 (acc. to GB4205-1993)
标准配置 Standard configuration	门板、箱体、密封条、接地套件、安装板、门锁 Door plate, box body, sealing strip, grounding set, mounting plate, door lock
钢板厚度 Plate thickness	箱体:1.5mm 门板:1.5mm 安装板:2.5mm Box body: 1.5mm Door plate: 1.5mm Mounting plate: 2.5mm



专用锁系统  
带双齿锁芯的专业锁系统  
Special lock system  
Professional lock system with double-teeth cylinder



旋转180° 锌合金铰链  
180° zinc alloy hinge



安装板  
Mounting plate

## 产品特点 Features of products

- 180度铰链确保门开启角度达到180度
- 箱口多层保护槽能起加固作用，不但能防止门板打开时脏物和水进入箱内，而且提供更大的箱口空间
- 镀锌钢板制成的安装板不但可以在箱外做布线使用，并提供更大的安装空间
- PU发泡密封条确保箱体达到IP56的防护等级
- 180o hinge allows 180o door opening
- Multiple protection grooves are designed at the box opening for reinforcement, which can prevent the entry of dirt or water when the door is opened, and offer a larger box opening space
- The mounting plate made of galvanized plate can be used for wiring outside the box and provide a larger mounting space
- PU foaming sealing strip ensures a protection grade of IP56 to box body

## EB系列订货规格表 EB series order specification table

序号 No.	订货号(RAL7032) Order No. (RAL7032)	订货号(RAL7035) Order No. (RAL7035)	宽 Width	高 Height	深 Depth
1	EB151508002	EB151508005	150	150	80
2	EB153008002	EB153008005	150	300	80
3	EB202008002	EB202008005	200	200	80
4	EB203008002	EB203008005	200	300	80
5	EB204008002	EB204008005	200	400	80
6	EB151512002	EB151512005	150	150	120
7	EB153012002	EB153012005	150	300	120
8	EB202012002	EB202012005	200	200	120
9	EB203012002	EB203012005	200	300	120
10	EB204012002	EB204012005	200	400	120
11	EB303012002	EB303012005	300	300	120
12	EB304012002	EB304012005	300	400	120
13	EB205012002	EB205012005	200	500	120
14	EB304015502	EB304015505	300	400	155
15	EB306015502	EB306015505	300	600	155
16	EB308015502	EB308015505	300	800	155

\*可定制非标产品 Nonstandard products are customizable

## EB系列尺寸规格表 EB series dimensions table

规格尺寸 Dimensions			宽度 Width			高度 Height			深度 Depth		安装板 Mounting plate		
宽 width	高 height	深 depth	B1	B2	B3	H1	H2	H3	T1	T2	F1	F2	G1
150	150	80	150	148	132	150	148	132	80	65	125	62.5	135
150	300	80	150	148	132	300	298	282	80	65	125	62.5	285
200	200	80	200	198	182	200	198	182	80	65	175	50	185
200	300	80	200	198	182	300	298	282	80	65	175	50	285
200	400	80	200	198	182	400	398	382	80	65	175	50	385
150	150	120	150	148	132	150	148	132	120	105	125	62.5	135
150	300	120	150	148	132	300	298	282	120	105	125	62.5	285
200	200	120	200	198	182	200	198	182	120	105	175	50	185
200	300	120	200	198	182	300	298	282	120	105	175	50	285
200	400	120	200	198	182	400	398	382	120	105	175	50	385
300	300	120	300	298	282	300	298	282	120	105	275	50	285
300	400	120	300	298	282	400	398	382	120	105	275	50	385
200	500	120	200	198	182	500	498	482	120	105	175	50	485
300	400	155	300	298	282	400	398	382	155	140	275	50	385
300	600	155	300	298	282	600	598	582	155	140	275	50	585
300	800	155	300	298	282	800	798	782	155	140	275	50	785

## EB系列细节图 EB series detail drawing

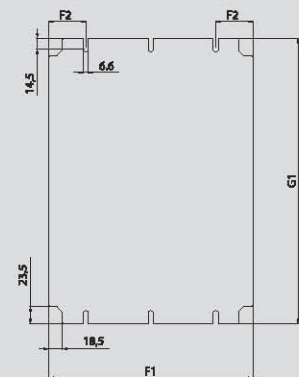
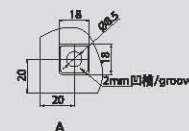
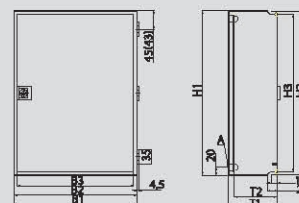

安装板细节图/Mounting Plate Detail Drawing

- 配置要求:  
1. 在EB箱高度≥500时配有两只FM小方锁;  
2. 在EB箱高度≥800时配有三只铰链;
- Configuration specification:  
1. EB box of a height ≥500, is provided with two small square locks;  
2. EB box of a height ≥800, is provided with three hinges;
- B1: 总宽度  
B2: 门的宽度  
B3: 箱体框架内的净宽度  
H1: 总高度  
H2: 门的高度  
H3: 箱体框架内的净高度  
T1: 总深度  
T2: 安装板到门板的距离  
F1: 安装板的总宽度  
F2: 安装板边到固定孔之间的距离  
G1: 安装板的总高度
- B1: Total width  
B2: Door width  
B3: Clear width in box frame  
H1: Total height  
H2: Door height  
H3: Clear height in box bottom frame  
T1: Total depth  
T2: Distance from mounting plate to door plate  
F1: Mounting plate overall width  
F2: Distance from mounting plate edge to mounting hole  
G1: Mounting plate total height

# KL接线箱系列

KL connection box series



材料 Material	冷轧钢板 Cold rolled steel sheet
表面处理 Surface treatment	箱体和门板磷化底涂处理, 外部为粉末涂层, 颜色可分RAL7032和RAL7035两种织纹 Etch primer for box body and door plate; powder coating for outside; RAL7032 or RAL7035 texture optional
防护等级 Protection grade	IP56(按GB4205-1993) IP56 (acc. to GB4205-1993)
标准配置 Standard configuration	门板、箱体、密封条、箱盖螺钉、安装板(可选) Door plate, box body, sealing strip, cover screw, mounting plate (option)
钢板厚度 Plate thickness	箱体: 1.5mm 门板: 1.5mm 安装板: 2.5mm Box body: 1.5mm Door plate: 1.5mm Mounting plate: 2.5mm



安装板  
镀锌安装板(可选件)  
Mounting plate  
Galvanized mounting plate (option)

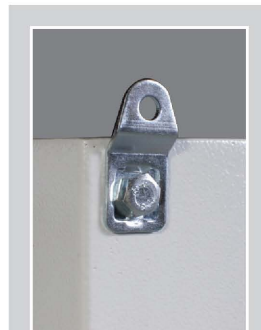

壁挂件  
Wall mounting parts



支撑轨  
可支撑接线板和输配电设备  
Supporting rail  
To support connection box and power transmission/distribution equipment

## 产品特点 Features of products

- 门板与箱体采用专用螺钉和护圈按通用标准安装，不但确保防护等级而且确保箱体在极狭小空间使用及维护
- 箱口多层保护槽不但能起加固作用而且能防止门板打开时脏物和水进入箱内
- PU发泡密封条确保箱体防护等级达到IP56
- 接地线可连接箱体和门板
- 箱体两侧配有开有螺丝孔的支架条，确保最大的安装高度，并可以安装支撑轨或安装板
- 特制的塑料绝缘套管不但能够密封而且能使门板螺丝不致脱落，并在螺丝拧紧时起导向的作用
- The door plate and box body are installed with special screws and retainers in accordance with common standards, which can ensure the Protection grade and the operation and maintenance in the narrow space in the box
- Multiple protection grooves are designed at the box opening can not only reinforce the structure but also prevent the entry of dirt or water when the door is opened
- PU foaming sealing strip ensures a protection grade of IP56 to box body
- The grounding can be connected to box body and door plate
- Racks with screw holes are provided on both sides of the box to ensure the max. mounting height and allow the installation of supporting rail or mounting plate
- The special plastic insulating sleeve can provide sealing and prevent door plate screw loosening, and guide screws when they are tightened

## KL系列订货规格表

### KL series order specification table

\*可定制非标产品  
Nonstandard products are customizable

序号 No.	订货号(RAL7032) Order No. (RAL7032)	订货号(RAL7035) Order No. (RAL7035)	宽 Width	高 Height	深 Depth
1	KL151508002	KL151508005	150	150	80
2	KL151512002	KL151512005	150	150	120
3	KL201508002	KL201508005	200	150	80
4	KL201512002	KL201512005	200	150	120
5	KL202008002	KL202008005	200	200	80
6	KL202012002	KL202012005	200	200	120
7	KL301508002	KL301508005	300	150	80
8	KL301512002	KL301512005	300	150	120
9	KL302008002	KL302008005	300	200	80
10	KL302012002	KL302012005	300	200	120
11	KL302015502	KL302015505	300	200	155
12	KL302021002	KL302021005	300	200	210
13	KL303012002	KL303012005	300	300	120
14	KL383021002	KL383021005	380	300	210
15	KL383821002	KL383821005	380	380	210
16	KL401512002	KL401512005	400	150	120
17	KL402008002	KL402008005	400	200	80
18	KL402012002	KL402012005	400	200	120
19	KL403012002	KL403012005	400	300	120
20	KL404012002	KL404012005	400	400	120
21	KL502012002	KL502012005	500	200	120
22	KL503012002	KL503012005	500	300	120
23	KL602008002	KL602008005	600	200	80
24	KL602012002	KL602012005	600	200	120
25	KL603012002	KL603012005	600	300	120
26	KL604012002	KL604012005	600	400	120

# AE挂壁箱系列

## AE wall mounted box series



材料 Material	冷轧钢板 Cold rolled steel sheet
表面处理 Surface treatment	箱体和前门磷化底涂处理，外部为粉末涂层，颜色可分RAL7032和RAL7035两种织纹，安装板则为镀锌 Etch primer for box body and front door; powder coating for outside; RAL7032 or RAL7035 texture optional; galvanized mounting plate
防护等级 Protection grade	IP56(按GB4205-1993) IP56 (acc. to GB4205-1993)
标准配置 Standard configuration	门板、箱体、密封条、接地套件、安装板、门锁 Door plate, box body, sealing strip, grounding set, mounting plate, door lock
钢板厚度 Plate thickness	箱体: 1.5mm 门板: 2.0mm 安装板: 2.5mm Box body: 1.5mm Door plate: 2.0mm Mounting plate: 2.5mm



防雨棚  
防止雨水直接流入  
Awning  
Prevent rainwater entering directly



壁挂件  
Wall mounting parts



限位器  
防止门打开后意外闭合，适用于户外、船舶等恶劣环境  
Limiter  
Prevent accidental closing of opened door, applicable for severe environments, e.g. outdoor, vessels

## 产品特点 Features of products

- PU发泡密封条确保箱体达到IP56的防护等级
- 各种类型及尺寸的凸台确保进出线方便
- 镀锌安装板也可在箱体外做布线用
- 箱口多层保护槽不但起加固作用而且能防止门板打开时脏物和水进入箱内
- 带双齿锁芯的专业锁系统开和关都极为便捷
- PU foaming sealing strip ensures a protection grade of IP56 to box body
- Bosses of various types and sizes allow easy installation of inlet/outlet lines
- Galvanized mounting plate can also be used for wiring outside the box
- Multiple protection grooves are designed at the box opening can not only reinforce the structure but also prevent the entry of dirt or water when the door is opened
- Professional lock system with double-teeth cylinder allows easy locking/unlocking

## AE系列订货规格表

### AE series order specification table

\*可定制非标产品  
Nonstandard products are customizable

序号 No.	订货号 (RAL7032) Order No. (RAL7032)	订货号 (RAL7035) Order No. (RAL7035)	宽 Width	高 Height	深 Depth	锁的数量 Lock quantity
1	AE203012002	AE203012005	200	300	120	单点固定锁1把 1 single-point lock
2	AE203015502	AE203015505	200	300	155	单点固定锁1把 1 single-point lock
3	AE203021002	AE203021005	200	300	210	单点固定锁1把 1 single-point lock
4	AE303021002	AE303021005	300	300	210	单点固定锁1把 1 single-point lock
5	AE304012002	AE304012005	300	400	120	单点固定锁1把 1 single-point lock
6	AE304015502	AE304015505	300	400	155	单点固定锁1把 1 single-point lock
7	AE304021002	AE304021005	300	400	210	单点固定锁1把 1 single-point lock
8	AE383015502	AE383015505	380	300	155	单点固定锁1把 1 single-point lock
9	AE383021002	AE383021005	380	300	210	单点固定锁1把 1 single-point lock
10	AE383821002	AE383821005	380	380	210	单点固定锁1把 1 single-point lock
11	AE386021002	AE386021005	380	600	210	单点固定锁2把 2 single-point lock
12	AE404015502	AE404015505	400	400	155	单点固定锁1把 1 single-point lock
13	AE405021002	AE405021005	400	500	210	单点固定锁1把 1 single-point lock
14	AE505021002	AE505021005	500	500	210	单点固定锁1把 1 single-point lock
15	AE505030002	AE505030005	500	500	300	单点固定锁1把 1 single-point lock
16	AE506021002	AE506021005	500	600	210	单点固定锁2把 2 single-point lock
17	AE603821002	AE603821005	600	380	210	单点固定锁1把 1 single-point lock
18	AE603835002	AE603835005	600	380	350	单点固定锁1把 1 single-point lock
19	AE606021002	AE606021005	600	600	210	单点固定锁2把 2 single-point lock
20	AE806025002	AE806025005	600	600	250	单点固定锁2把 2 single-point lock
21	AE606030002	AE606030005	600	600	300	单点固定锁2把 2 single-point lock
22	AE606035002	AE606035005	600	600	350	单点固定锁2把 2 single-point lock
23	AE607621002	AE607621005	600	760	210	单点固定锁2把 2 single-point lock
24	AE607625002	AE607625005	600	760	250	单点固定锁2把 2 single-point lock
25	AE607635002	AE607635005	600	760	350	单点固定锁2把 2 single-point lock

# BAE不锈钢挂壁箱系列

BAE stainless steel wall-mounted box



材料 Material	SUS304(其它材料型号可选) SUS304 (other material types are option)
表面处理 Surface treatment	拉丝, 安装板则为镀锌 Wire drawing; galvanized mounting plate
防护等级 Protection grade	IP56(按GB4205-1993) IP56 (acc. to GB4205-1993)
标准配置 Standard configuration	门板、箱体、密封条、接地套件、安装板、门锁 Door plate, box body, sealing strip, grounding set, mounting plate, door lock
钢板厚度 Plate thickness	箱体: 1.5mm 门板: 2.0mm 安装板: 2.5mm Box body: 1.5mm Door plate: 2.0mm Mounting plate: 2.5mm



壁挂件(SUS304)  
Wall mounting parts (SUS304)



防水铆接螺栓  
(可配合壁挂件使用)  
Waterproof riveted bolt (Can be used together with Wall mounting parts)



内部接地和130°  
防水铰链  
Internal grounding and 130° waterproof hinge

## 产品特点 Features of products

- PU发泡密封条确保箱体达到IP56的防护等级
- 镀锌安装板也可在箱体外做布线用
- 箱口多层保护槽不但起加固作用而且能防止门板打开时脏物和水进入箱内
- 专用的带双齿锁芯SUS304材质的不锈钢锁系统彰显档次，确保通用性
- 表面拉丝处理（高档箱体内部可做喷砂处理）
- PU foaming sealing strip ensures a protection grade of IP56 to box body
- Galvanized mounting plate can also be used for wiring outside the box
- Multiple protection grooves are designed at the box opening can not only reinforce the structure but also prevent the entry of dirt or water when the door is opened
- Special SUS304 stainless steel lock system with double-teeth cylinder shows high quality and ensures universality
- Surface wire drawing treatment (sand blasting is available in high-class box)

## BAE系列订货规格表 BAE series order specification table

序号 No.	订货号 Order No.	宽 Width	高 Height	深 Depth	锁的数量 Lock quantity
1	BAE2030120304	200	300	120	单点固定锁1把 1 single-point lock
2	BAE2030155304	200	300	155	单点固定锁1把 1 single-point lock
3	BAE2030210304	200	300	210	单点固定锁1把 1 single-point lock
4	BAE3030210304	300	300	210	单点固定锁1把 1 single-point lock
5	BAE3040120304	300	400	120	单点固定锁1把 1 single-point lock
6	BAE3040155304	300	400	155	单点固定锁1把 1 single-point lock
7	BAE3040210304	300	400	210	单点固定锁1把 1 single-point lock
8	BAE3830155304	380	300	155	单点固定锁1把 1 single-point lock
9	BAE3830210304	380	300	210	单点固定锁1把 1 single-point lock
10	BAE3838210304	380	380	210	单点固定锁1把 1 single-point lock
11	BAE3860210304	380	600	210	单点固定锁2把 2 single-point lock
12	BAE4040155304	400	400	155	单点固定锁1把 1 single-point lock
13	BAE4050210304	400	500	210	单点固定锁1把 1 single-point lock
14	BAE5050210304	500	500	210	单点固定锁1把 1 single-point lock
15	BAE5050300304	500	500	300	单点固定锁1把 1 single-point lock
16	BAE5060210304	500	600	210	单点固定锁2把 2 single-point lock
17	BAE6038210304	600	380	210	单点固定锁1把 1 single-point lock
18	BAE6038350304	600	380	350	单点固定锁1把 1 single-point lock
19	BAE6060210304	600	600	210	单点固定锁2把 2 single-point lock
20	BAE6060250304	600	600	250	单点固定锁2把 2 single-point lock
21	BAE6060300304	600	600	300	单点固定锁2把 2 single-point lock
22	BAE6060350304	600	600	350	单点固定锁2把 2 single-point lock
23	BAE6076210304	600	760	210	单点固定锁2把 2 single-point lock
24	BAE6076250304	600	760	250	单点固定锁2把 2 single-point lock
25	BAE6076350304	600	760	350	单点固定锁2把 2 single-point lock

# AE立式控制箱系列

AE vertical control box series



材料 Material	冷轧钢板 Cold rolled steel sheet
表面处理 Surface treatment	箱体和门板磷化底涂处理，外部为粉末涂层，颜色可分RAL7032和RAL7035两种织纹，安装板则为镀锌 Etch primer for box body and door plate; powder coating for outside; RAL7032 or RAL7035 texture optional; galvanized mounting plate
防护等级 Protection grade	IP56(按GB4205-1993) IP56 (acc. to GB4205-1993)
标准配置 Standard configuration	门板、箱体、密封条、接地套件、安装板、门锁(岔道锁) Door plate, box body, sealing strip, grounding set, mounting plate, door lock (turnoff lock)
钢板厚度 Plate thickness	箱体: 1.5mm (可选2.0mm) 门板: 2.0mm 安装板: 2.5mm Box body: 1.5mm (2.0mm option) Door plate: 2.0mm Mounting plate: 2.5mm



接地线  
Grounding wire



进出线凸台  
Inlet/outlet line base



岔道锁  
Turnoff lock

## 产品特点 Features of products

- PU发泡密封条确保箱体达到IP56的防护等级
- 各种类型及尺寸的凸台确保进出线方便
- 镀锌安装板也可在箱体外做布线用
- 箱口多层保护槽不但起加固作用而且能防止门板打开时脏物和水进入箱内
- 带双齿锁芯的岔道锁系统开和关不但极为便捷，而且确保了其通用性
- 两侧带折边的安装板和安装支架最大限度的确保了安装强度
- PU foaming sealing strip ensures a protection grade of IP56 to box body
- Bosses of various types and sizes allow easy installation of inlet/outlet lines
- Galvanized mounting plate can also be used for wiring outside the box
- Multiple protection grooves are designed at the box opening can not only reinforce the structure but also prevent the entry of dirt or water when the door is opened
- Professional turnoff lock system with double-teeth cylinder allows easy locking/unlocking and universality
- Mounting plate and supporting rack with flanges on both sides ensures the max. mounting strength

## AE系列订货规格表

### Specifications of AE series

\*可定制非标产品  
Nonstandard products are customizable

序号 No.	订货号 (RAL7032) Order No. (RAL7032)	订货号 (RAL7035) Order No. (RAL7035)	宽 Width	高 Height	深 Depth	锁的数量 Lock quantity
1	AE608025002	AE608025005	600	800	250	单点固定锁2把 (岔道锁为1把) 2 single-point lock (1 turnoff lock)
2	AE608030002	AE608030005	600	800	300	单点固定锁2把 (岔道锁为1把) 2 single-point lock (1 turnoff lock)
3	AE609030002	AE609030005	600	900	300	单点固定锁2把 (岔道锁为1把) 2 single-point lock (1 turnoff lock)
4	AE601025002	AE601025005	600	1000	250	单点固定锁2把 (岔道锁为1把) 2 single-point lock (1 turnoff lock)
5	AE601225002	AE601225005	600	1200	250	单点固定锁2把 (岔道锁为1把) 2 single-point lock (1 turnoff lock)
6	AE601230002	AE601230005	600	1200	300	单点固定锁2把 (岔道锁为1把) 2 single-point lock (1 turnoff lock)
7	AE767621002	AE767621005	760	760	210	单点固定锁2把 (岔道锁为1把) 2 single-point lock (1 turnoff lock)
8	AE767630002	AE767630005	760	760	300	单点固定锁2把 (岔道锁为1把) 2 single-point lock (1 turnoff lock)
9	AE808030002	AE808030005	800	800	300	单点固定锁2把 (岔道锁为1把) 2 single-point lock (1 turnoff lock)
10	AE801025002	AE801025005	800	1000	250	单点固定锁2把 (岔道锁为1把) 2 single-point lock (1 turnoff lock)
11	AE801030002	AE801030005	800	1000	300	单点固定锁2把 (岔道锁为1把) 2 single-point lock (1 turnoff lock)
12	AE801230002	AE801230005	800	1200	300	单点固定锁2把 (岔道锁为1把) 2 single-point lock (1 turnoff lock)
13	AE107621002	AE107621005	1000	760	210	单点固定锁2把 (岔道锁为1把) 2 single-point lock (1 turnoff lock)
14	AE107630002	AE107630005	1000	760	300	单点固定锁2把 (岔道锁为1把) 2 single-point lock (1 turnoff lock)
15	AE101030002	AE101030005	1000	1000	300	单点固定锁2把 (岔道锁为1把) 2 single-point lock (1 turnoff lock)
16	AE101230002	AE101230005	1000	1200	300	单点固定锁2把 (岔道锁为1把) 2 single-point lock (1 turnoff lock)

# BAE不锈钢立式控制箱系列

BAE stainless steel vertical control box series



材料 Material	SUS304 (其它材料型号可选) SUS304 (other material types are option)
表面处理 Surface treatment	拉丝, 安装板则为镀锌 Wire drawing; galvanized mounting plate
防护等级 Protection grade	IP56(按GB4205-1993) IP56 (acc. to GB4205-1993)
标准配置 Standard configuration	门板、箱体、密封条、接地套件、安装板、门锁 Door plate, box body, sealing strip, grounding set, mounting plate, door lock
钢板厚度 Plate thickness	箱体: 1.5mm(可选2.0mm) 门板: 2.0mm 安装板: 2.5mm Box body: 1.5mm (2.0mm option) Door plate: 2.0mm Mounting plate: 2.5mm



壁挂件  
Wall mounting parts



防雨顶罩  
Rain hood

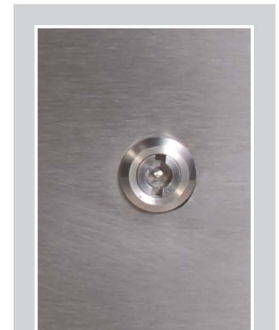

不锈钢锁(可选不锈钢岔道锁系统)  
Stainless steel lock (stainless steel turnoff lock system optional)

## 产品特点 Features of products

- PU发泡密封条确保箱体达到IP56的防护等级
- 镀锌安装板也可在箱体外做布线用
- 箱口多层保护槽不但起加固作用而且能防止门板打开时脏物和水进入箱内
- 专用的带双齿锁芯SUS304材质的不锈钢锁系统彰显档次，确保通用性
- 表面拉丝处理(高档箱体内部可做喷砂处理)
- 带折边的安装板和安装板支架最大限度的确保安装强度
- PU foaming sealing strip ensures a protection grade of IP56 to box body
- Galvanized mounting plate can also be used for wiring outside the box
- Multiple protection grooves are designed at the box opening can not only reinforce the structure but also prevent the entry of dirt or water when the door is opened
- Special SUS304 stainless steel lock system with double-teeth cylinder shows high quality and ensures universality
- Surface wire drawing treatment (sand blasting is available in high-class box)
- Mounting plate and supporting rack with flanges ensures the max. mounting strength

## BAE系列订货规格表 BAE series order specification table

\*可定制非标产品  
Nonstandard products are customizable

序号 No.	订货号 Order No.	宽 Width	高 Height	深 Depth	锁的数量 Lock quantity
1	BAE6080250304	600	800	250	单点固定锁2把 (岔道锁为1把) 2 single-point lock (1 turnoff lock)
2	BAE6080300304	600	800	300	单点固定锁2把 (岔道锁为1把) 2 single-point lock (1 turnoff lock)
3	BAE6090300304	600	900	300	单点固定锁2把 (岔道锁为1把) 2 single-point lock (1 turnoff lock)
4	BAE6010250304	600	1000	250	单点固定锁2把 (岔道锁为1把) 2 single-point lock (1 turnoff lock)
5	BAE6012250304	600	1200	250	单点固定锁2把 (岔道锁为1把) 2 single-point lock (1 turnoff lock)
6	BAE6012300304	600	1200	300	单点固定锁2把 (岔道锁为1把) 2 single-point lock (1 turnoff lock)
7	BAE7676210304	760	760	210	单点固定锁2把 (岔道锁为1把) 2 single-point lock (1 turnoff lock)
8	BAE7676300304	760	760	300	单点固定锁2把 (岔道锁为1把) 2 single-point lock (1 turnoff lock)
9	BAE8080300304	800	800	300	单点固定锁2把 (岔道锁为1把) 2 single-point lock (1 turnoff lock)
10	BAE8010250304	800	1000	250	单点固定锁2把 (岔道锁为1把) 2 single-point lock (1 turnoff lock)
11	BAE8010300304	800	1000	300	单点固定锁2把 (岔道锁为1把) 2 single-point lock (1 turnoff lock)
12	BAE8012300304	800	1200	300	单点固定锁2把 (岔道锁为1把) 2 single-point lock (1 turnoff lock)
13	BAE1076210304	1000	760	210	单点固定锁2把 (岔道锁为1把) 2 single-point lock (1 turnoff lock)
14	BAE1076300304	1000	760	300	单点固定锁2把 (岔道锁为1把) 2 single-point lock (1 turnoff lock)
15	BAE1010300304	1000	1000	300	单点固定锁2把 (岔道锁为1把) 2 single-point lock (1 turnoff lock)
16	BAE1012300304	1000	1200	300	单点固定锁2把 (岔道锁为1把) 2 single-point lock (1 turnoff lock)

# AK 立式控制箱系列

AK vertical control box series



材料 Material	冷轧钢板 Cold rolled steel sheet
表面处理 Surface treatment	箱体和门板磷化底涂处理, 外部为粉末涂层, 可分RAL7032或RAL7035两种织纹, 安装板则为镀锌 Etch primer for box body and door plate; powder coating for outside; RAL7032 or RAL7035 texture optional; galvanized mounting plate
防护等级 Protection grade	IP56(按GB4205-1993) IP56 (acc. to GB4205-1993)
标准配置 Standard configuration	门板、箱体、密封条、接地套件、安装板、门锁、运输吊环(可选) Door plate, box body, sealing strip, grounding set, mounting plate, door lock, lifting ring (option)
钢板厚度 Plate thickness	箱体: 1.5mm (可选2.0mm) 门板: 2.0mm 安装板: 标配2.5mm (可选3.0) Box body: 1.5mm (2.0mm option) Door plate: 2.0mm Mounting plate: standard 2.5mm(3.0 option)



坚固的门板方管加强筋  
Firm door plate square tube stiffener



加强的多折箱体边框  
灵活的底部进出线方式  
Reinforced folded box frame; flexible bottom inlet/outlet line mode

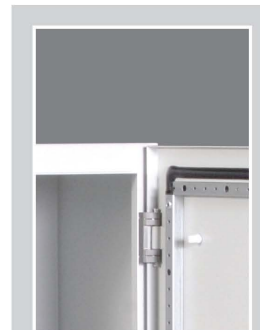

锌合金130° 承重铰链  
高强度的安装板支架  
Zinc alloy 130° bearing hinge  
High strength mounting plate rack

## 产品特点 Features of products

- PU发泡的密封条确保箱体达到IP56的防护等级
- 加宽的箱体边框、承重铰链、门板方管加强筋确保箱体系统的高强度
- 可选3.0mm的镀锌安装板和高强度的安装板支架确保安装器件的可靠性(可在箱外做布线用)
- 底部进出线装置确保进出线的灵活方便
- 可选的运输吊环系统确保运输的方便快捷
- PU foaming sealing strip ensures a protection grade of IP56 to box body
- Widened box frame, bearing hinge and door plate square tube stiffener ensures high strength of the box body
- Optional 3.0mm galvanized mounting plate and high-strength mounting rack ensures the reliability of the mounting parts (can be used for wiring outside the box)
- Bottom inlet/outlet line device allows easy installation of inlet/outlet lines
- Optional lifting ring system allows easy handling

## AK系列订货规格表 AK series order specification table

\*可定制非标产品  
Nonstandard products are customizable

序号	订货号(RAL7032)	订货号(RAL7035)	宽	高	深
1	AK601440002	AK601440005	600	1400	400
2	AK801440002	AK801440005	800	1400	400
3	AK121440002	AK121440005	1200	1400	400

## 凸台

### Base

## AE/AK箱体凸台选用型号表 AE/AK box base selection table

柜宽 Cabinet Width	柜深(含门) Cabinet depth (including door)	标配凸台型号 Standard boss type	凸台外形 尺寸大小(mm) Boss dimensions (mm)	凸台有效使用 空间尺寸大(mm) Boss effective space dimensions (mm)
600(含以上)/600 (or above)	250(含以上)/250 (or above)	1号凸台/Boss 1	550×165	500×115
500(含以上)/500 (or above)	210(含以上)/220 (or above)	2号凸台/Boss 1	430×150	380×100
400(含以上)/400 (or above)	190(含以上)/190 (or above)	3号凸台/Boss 1	330×130	280×80
350(含以上)/350 (or above)	155(含以上)/155 (or above)	4号凸台/Boss 1	270×105	230×60
300(含以上)/300 (or above)	155(含以上)/155 (or above)	5号凸台/Boss 1	220×100	180×60
200(含以上)/200 (or above)	120(含以上)/120 (or above)	6号凸台/Boss 1	150×80	110×40

## 凸台细节图

### Base detail drawing

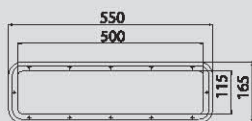

1号凸台 Base 1

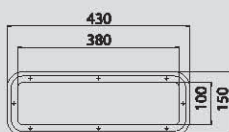

2号凸台 Base 2

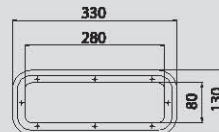

3号凸台 Base 3

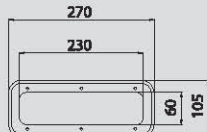

4号凸台 Base 4

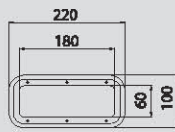

5号凸台 Base 5

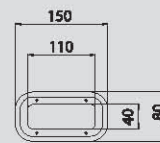

6号凸台 Base 6

# ES独立式控制柜系列

ES stand-alone control cabinet series



材料 Material	冷轧钢板 Cold rolled steel sheet
表面处理 Surface treatment	机柜磷化底涂处理，外部为粉末涂层，颜色可分RAL7032和RAL7035两种织纹，安装板则为镀锌 Etch primer for cabinet; powder coating for outside; RAL7032 or RAL7035 texture optional; galvanized mounting plate
防护等级 Protection grade	IP55(按GB4205-1993) IP55 (acc. to GB4205-1993)
标准配置 Standard configuration	前门、背板、安装板、柜体、门锁、密封条 Front door, back plate, mounting plate, cabinet, door lock, sealing strip
钢板厚度 Plate thickness	框架：五折型材1.5mm 门板：2.0mm 背板：1.5mm 安装板：2.5mm (可选3.0mm) Frame: 5-fold sections 1.5mm Door plate: 2.0mm Back plate: 1.5mm Mounting plate: 2.5mm (3.0mm option)



五折结构框架  
5-fold structural frame



加强方管与A3资料盒  
Reinforcing square tube and A3 document box



三段活动进出线装置  
Three-section flexible inlet/outlet line device

## 产品特点 Features of product

- 独立式电柜，不适宜并柜使用
- 门板离地很高，约25mm，确保开门灵活顺畅
- 独特的五折型材整体焊接而成的主体框架不但确保柜体的高强度而且使柜体的防护等级达到IP56
- 特殊的门板方管加强系统可以用螺丝固定在门板上，便于拆卸
- 框架上密布的25mm 间距模数孔确保安装的灵活性、通用性
- 可选3.0mm的镀锌安装板可以利用塑料滑块通过导轨从正面推入柜内，且两边有U型折边使安装板更牢固和更便于搬运
- Stand-alone electric cabinet, inapplicable for cabinet incorporation
- High door plate (approx 25mm from the ground) to ensure smooth door opening
- IP56 Unique main body frame integrally welded with 5-fold sections ensures high strength and IP56 of cabinet body
- Special door plate square tube reinforcing system can be fixed on door plate by screws for easy disassembly
- Modular holes with a spacing of 25mm on the frame ensures flexibility and universality of installation
- Optional 3.0mm galvanized mounting plate can be pushed into the cabinet by plastic slide through rail; U flanges on both sides allow firmer mounting plate and easier handling

## ES系列订货规格表

### ES series order specification table

\*可定制非标产品  
Nonstandard products are customizable

序号 No.	订货号(RAL7032) Order No. (RAL7032)	订货号(RAL7035) Order No. (RAL7035)	宽 Width	高 Height	深 Depth
1	ES601640002	ES601640005	600	1600	400
2	ES601650002	ES601650005	600	1600	500
3	ES801650002	ES801650005	800	1600	500
4	ES121650002	ES121650005	1200	1600	500
5	ES601840002	ES601840005	600	1800	400
6	ES601850002	ES601850005	600	1800	500
7	ES801840002	ES801840005	800	1800	400
8	ES801850002	ES801850005	800	1800	500
9	ES101840002	ES101840005	1000	1800	400
10	ES121840002	ES121840005	1200	1800	400
11	ES161840002	ES161840005	1600	1800	400
12	ES602050002	ES602050005	600	2000	500
13	ES602060002	ES602060005	600	2000	600
14	ES802060002	ES802060005	800	2000	500
15	ES802060002	ES802060005	800	2000	600
16	ES102050002	ES102050005	1000	2000	500
17	ES102060002	ES102060005	1000	2000	600
18	ES122050002	ES122050005	1200	2000	500
19	ES122060002	ES122060005	1200	2000	600
20	ES122080002	ES122080005	1200	2000	800
21	ES182050002	ES182050005	1800	2000	500
22	ES602250002	ES602250005	600	2200	500
23	ES602260002	ES602260005	600	2200	600
24	ES802260002	ES802260005	800	2200	600
25	ES102250002	ES102250005	1000	2200	500
26	ES102260002	ES102260005	1000	2200	600
27	ES122260002	ES122260005	1200	2200	600
28	ES122280002	ES122280005	1200	2200	800
29	ES802050002	ES802050005	800	2000	500
30	ES802250002	ES802250005	800	2200	500
31	ES102080002	ES102080005	1000	2000	800
32	ES122250002	ES122250005	1200	2200	500
33	ES802280002	ES802280005	800	2200	800
34	ES102280002	ES102280005	1000	2200	800

# BES独立式控制柜系列

BES stand-alone control cabinet series



材料 Material	SUS304 (其它材料型号可选) SUS304 (other material types are optional)
表面处理 Surface treatment	拉丝, 安装板则为镀锌 Wire drawing, and mounting plate is galvanized
防护等级 Protection grade	IP55(按GB4205-1993) IP55 (in the light of GB4205-1993)
标准配置 Standard configuration	前门、背板、安装板、柜体、门锁、密封条 Front door, back plate, mounting plate, cabinet body, door lock and sealing strip
钢板厚度 Plate thickness	框架: 五折型材 1.5mm 门板: 2.0mm 背板: 1.5mm 安装板: 2.5mm (可选3.0mm) Frame: five-fold section 1.5mm Door plate: 2.0mm Back plate: 1.5mm Mounting plate: 2.5mm (3.0mm option)



不锈钢承重吊环  
Stainless steel bearing suspension loop

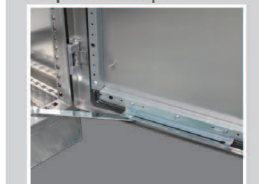

限位器  
Stopper



不锈钢平面锁  
Stainless steel flat lock



不锈钢A3文件夹  
Stainless steel A3 folder



密封条/高强度方管  
Sealing strip/high strength square pipe



挂耳纵梁  
Longeron with suspension loop

### 产品特点 Features of product

- 独立式电柜，不适宜并柜使用
- 门板离地很高，约25mm，确保开门灵活顺畅
- 独特的五折型材整体焊接而成的主体框架不但确保柜体的高强度而且确保柜体的防护等级达到IP56
- 特殊的门板方管加强系统可以用螺丝固定在门板上，便于拆卸
- 框架上密布的25mm 间距模数孔确保安装的灵活性、通用性
- 可选3.0mm的镀锌安装板可以利用塑料滑块通过导轨从正面推入柜内，且两边有U型折边使安装板更牢固和更便于搬运
- 专业的不锈钢岔道锁、不锈钢承重吊环以及各种功能性的附件彰显柜体豪华品质
- Stand-alone electric cabinet, unsuitable for combination
- Ground clearance of door plate is sufficient, about 25mm, ensuring flexibility and smoothness of door opening.
- IP56The main body frame specially fabricated by five-fold section through whole welding ensures not only high strength but also the Protection grade of IP56.
- Special door plate square pipe reinforcement system can be fixed on the door plate with screws, easy for dismantlement.
- Module holes densely distributed at 25mm spacing on the frame guarantee flexibility and universality of installation
- The optional 3.0mm galvanized mounting plate can be pushed into the cabinet from the front through guide rail by making use of plastic sliders. U-shape folded edges at the two sides facilitate fastening and handling of the mounting plate.
- Professional stainless steel turnoff lock, stainless steel bearing suspension loops and other accessories having various functions bring out luxury character of cabinet body.

### BES系列订货规格表

#### BES series order specification table

\*可定制非标产品  
Nonstandard products are customizable

序号No.	订货号Order No.	宽 Width	高 Height	深 Depth
1	BES6016400304	600	1600	400
2	BES6016500304	600	1600	500
3	BES8016500304	800	1600	500
4	BES1216500304	1200	1600	500
5	BES6018400304	600	1800	400
6	BES6018500304	600	1800	500
7	BES8018400304	800	1800	400
8	BES8018500304	800	1800	500
9	BES1018400304	1000	1800	400
10	BES1218400304	1200	1800	400
11	BES1618400304	1600	1800	400
12	BES6020500304	600	2000	500
13	BES6020600304	600	2000	600
14	BES8020600304	800	2000	500
15	BES8020600304	800	2000	600
16	BES1020500304	1000	2000	500
17	BES1020600304	1000	2000	600
18	BES1220500304	1200	2000	500
19	BES1220600304	1200	2000	600
20	BES1220800304	1200	2000	800
21	BES1820500304	1800	2000	500
22	BES6022500304	600	2200	500
23	BES6022600304	600	2200	600
24	BES8022600304	800	2200	600
25	BES1022500304	1000	2200	500
26	BES1022600304	1000	2200	600
27	BES1222600304	1200	2200	600
28	BES1222800304	1200	2200	800
29	BES8020500304	800	2000	500
30	BES8022500304	800	2200	500
31	BES1020800304	1000	2000	800
32	BES1222500304	1200	2200	500
33	BES8022800304	800	2200	800
34	BES1022800304	1000	2200	800

# PS组合柜系列

## PS combined cabinet series



材料 Material	冷轧钢板 Cold-roll steel sheet
表面处理 Surface treatment	机柜磷化底涂处理，外部为粉末涂层，颜色可分RAL7032和RAL7035两种纹理，安装板则为镀锌 Cabinet is applied with etch primer and covered with powder coating on the outer side. Two color textures, RAL7032 and RAL7035, are available. The mounting plate is galvanized.
防护等级 Protection grade	IP54 (按GB4205-1993) IP54 (in accordance with GB4205-1993)
标准配置 Standard configuration	前门、背板、安装板、柜体、密封条、门锁、侧板(可选) Front door, back plate, mounting plate, cabinet body, sealing strip, door lock and side plate (optional)
钢板厚度 Plate thickness	框架：九折型材1.5mm 门板：2.0mm 背板、侧板：1.5mm 安装板：2.5mm (可选3.0mm) Frame: nine-fold section 1.5mm Door plate: 2.0mm Back plate and side plate: 1.5mm Mounting plate: 2.5mm (3.0mm option)



托架台面  
Bracket table board



并柜补板  
Cabinet combination patch



豪华照明灯系统  
Luxury light system



A3文件夹/限位器  
A3 folder/stopper

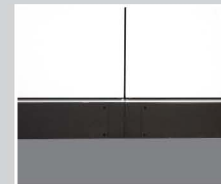

活动底座  
Movable base



门托架  
Door bracket

## 产品特点 Features of product

- 组合式电柜，适宜并柜使用
- 顶板可以移去，侧板可以拆卸，更易于工作的便捷性
- 门板离地很高，约25mm，确保开门灵活顺畅
- 独特的九折型材整体焊接而成的主体框架不但确保柜体的高强度而且使柜体的防护等级达到IP56
- 特殊的门板方管加强系统可以用螺丝固定在门板上，便于拆卸
- 框架上密布的25mm 间距模数孔确保安装的灵活性、通用性
- 可选3.0mm的镀锌安装板可以利用塑料滑块通过导轨从正面推入柜内，且两边有U型折边使安装板更牢固和更便于搬运
- Combined electric cabinet, suitable for combination
- The top plate is removable and the side plate is demountable, making work easier and simpler
- Ground clearance of door plate is sufficient, about 25mm, ensuring flexibility and smoothness of door opening.
- IP56The main body frame specially made of nine-fold section by means of whole welding not only ensures high strength of cabinet body but also lets the protection grade of cabinet body reach IP56.
- Special door plate square pipe reinforcement system can be fixed on the door plate with screws, easy for dismantlement.
- Module holes densely distributed at 25mm spacing on the frame guarantee the flexibility and universality of installation
- The optional 3.0mm galvanized mounting plate can be pushed into the cabinet from the front through guide rail by making use of plastic sliders. U-shape folded edges at the two sides facilitate fastening and handling of the mounting plate.

## PS系列订货规格表

### PS series order specification table

\*可定制非标产品  
Nonstandard products are customizable

序号 No.	柜体订货号(RAL7032) Order number of cabinet body (RAL7032)	侧板订货号(RAL7032) Order number of side plate (RAL7032)	柜体订货号(RAL7035) Order number of cabinet body (RAL7035)	侧板订货号(RAL7035) Order number of side plate (RAL7035)	宽 Width	高 Height	深 Depth
1	PS601840002	PS1840002	PS601840005	PS1840005	600	1800	400
2	PS801840002	PS1840002	PS801840005	PS1840005	800	1800	400
3	PS101840002	PS1840002	PS101840005	PS1840005	1000	1800	400
4	PS121840002	PS1840002	PS121840005	PS1840005	1200	1800	400
5	PS601850002	PS1850002	PS601850005	PS1850005	600	1800	500
6	PS801850002	PS1850002	PS801850005	PS1850005	800	1800	500
7	PS121850002	PS1850002	PS121850005	PS1850005	1200	1800	500
8	PS601860002	PS1860002	PS601860005	PS1860005	600	1800	600
9	PS801860002	PS1860002	PS801860005	PS1860005	800	1800	600
10	PS121860002	PS1860002	PS121860005	PS1860005	1200	1800	600
11	PS602040002	PS2040002	PS602040005	PS2040005	600	2000	400
12	PS802040002	PS2040002	PS802040005	PS2040005	800	2000	400
13	PS122040002	PS2040002	PS122040005	PS2040005	1200	2000	400
14	PS602050002	PS2050002	PS602050005	PS2050005	600	2000	500
15	PS802050002	PS2050002	PS802050005	PS2050005	800	2000	500
16	PS102050002	PS2050002	PS102050005	PS2050005	1000	2000	500
17	PS122050002	PS2050002	PS122050005	PS2050005	1200	2000	500
18	PS602060002	PS2060002	PS602060005	PS2060005	600	2000	600
19	PS802060002	PS2060002	PS802060005	PS2060005	800	2000	600
20	PS102060002	PS2060002	PS102060005	PS2060005	1000	2000	600
21	PS122060002	PS2060002	PS122060005	PS2060005	1200	2000	600
22	PS602080002	PS2080002	PS602080005	PS2080005	600	2000	800
23	PS802080002	PS2080002	PS802080005	PS2080005	800	2000	800
24	PS122080002	PS2080002	PS122080005	PS2080005	1200	2000	800
25	PS602260002	PS2260002	PS602260005	PS2260005	600	2200	600
26	PS802260002	PS2260002	PS802260005	PS2260005	800	2200	600
27	PS122260002	PS2260002	PS122260005	PS2260005	1200	2200	600

# BPS不锈钢组合柜系列

BPS stainless steel combined cabinet series



材料 Material	SUS304 (其它材料型号可选)SUS304 (other material types are optional)
表面处理 Surface treatment	拉丝, 安装板则为镀锌Wire drawing, and mounting plate is galvanized
防护等级 Protection grade	IP54 (按GB4205-1993) IP54 (in accordance with GB4205-1993)
标准配置 Standard configuration	前门、背板、安装板、柜体、密封条、门锁、侧板(可选件)Front door, back plate, mounting plate, cabinet body, sealing strip, door lock and side plate (optional)
钢板厚度 Plate thickness	框架: 九折型材1.5mm 门板: 2.0mm 背板、侧板: 1.5mm 安装板: 2.5mm (可选3.0mm) Frame: nine-fold section 1.5mm Door plate: 2.0mm Back plate and side plate: 1.5mm Mounting plate: 2.5mm (3.0mm option)



限位器/铰链/加强方管  
Stopper/hinge/  
reinforced square pipe



固定底座  
Fixing base



不锈钢三通连接件  
Stainless steel three-way connection element

## 产品特点 Features of product

- 组合式电柜，适宜并柜使用
- 顶板可以移去，侧板可以脱卸，更易于工作的便捷性
- 门板离地很高，约25mm，确保开门灵活顺畅
- 独特的九折型材配合高强度的不锈钢三通连接件焊接而成的主体框架确保柜体的高强度
- 特殊的门板方管加强系统可以用螺丝固定在门板上，便于拆卸
- 框架上密布的25mm 间距模数孔确保安装的灵活性、通用性
- 可选3.0mm的镀锌安装板可以利用塑料滑块通过导轨从正面推入柜内，且两边有U型折边使安装板更牢固和更便于搬运
- 专业的不锈钢岔道锁、不锈钢承重吊环以及各种功能性的附件彰显柜体豪华品质

- Combined electric cabinet, suitable for combination
- The top plate is removable and the side plate is demountable, making work easier and simpler
- Ground clearance of door plate is sufficient, about 25mm, ensuring flexibility and smoothness of door opening.
- The main body frame specially made of nine-fold section and high-strength stainless steel three-way connection elements through welding ensures high strength of cabinet body.
- Special door plate square pipe reinforcement system can be fixed on the door plate with screws, easy for dismantlement.
- Module holes densely distributed at 25mm spacing on the frame guarantee the flexibility and universality of installation
- The optional 3.0mm galvanized mounting plate can be pushed into the cabinet from the front through guide rail by making use of plastic sliders. U-shape folded edges at the two sides facilitate fastening and handling of the mounting plate.
- Professional stainless steel turnoff lock, stainless steel bearing suspension loops and other accessories of various functions bring out luxury character of cabinet body.

## BPS系列订货规格表

BPS series order specification table

\*可定制非标产品  
Nonstandard products are customizable

序号/No.	柜体订货号 Order number of cabinet body	侧板订货号 Order number of side plate	宽 Width	高 Height	深 Depth
1	BPS6018400304	BPS18400304	600	1800	400
2	BPS8018400304	BPS18400304	800	1800	400
3	BPS1018400304	BPS18400304	1000	1800	400
4	BPS1218400304	BPS18400304	1200	1800	400
5	BPS6018500304	BPS18500304	600	1800	500
6	BPS8018500304	BPS18500304	800	1800	500
7	BPS1218500304	BPS18500304	1200	1800	500
8	BPS6018600304	BPS18600304	600	1800	600
9	BPS8018600304	BPS18600304	800	1800	600
10	BPS1218600304	BPS18600304	1200	1800	600
11	BPS6020400304	BPS20400304	600	2000	400
12	BPS8020400304	BPS20400304	800	2000	400
13	BPS1220400304	BPS20400304	1200	2000	400
14	BPS6020500304	BPS20500304	600	2000	500
15	BPS8020500304	BPS20500304	800	2000	500
16	BPS1020500304	BPS20500304	1000	2000	500
17	BPS1220500304	BPS20500304	1200	2000	500
18	BPS6020600304	BPS20600304	600	2000	600
19	BPS8020600304	BPS20600304	800	2000	600
20	BPS1020600304	BPS20600304	1000	2000	600
21	BPS1220600304	BPS20600304	1200	2000	600
22	BPS6020800304	BPS20800304	600	2000	800
23	BPS8020800304	BPS20800304	800	2000	800
24	BPS1220800304	BPS20800304	1200	2000	800
25	BPS6022600304	BPS22600304	600	2200	600
26	BPS8022600304	BPS22600304	800	2200	600
27	BPS1222600304	BPS22600304	1200	2200	600

# PC电脑柜系列

PC computer cabinet series



材料 Material	冷轧钢板、铝合金型材 Cold-roll steel sheet and aluminum alloy section
表面处理 Surface treatment	机柜磷化底涂处理，外部为粉末涂层，颜色RAL7035，装饰条RAL5018两种织纹，层板与柜体同色 Cabinet is applied with etch primer and covered with powder coating on the outer side, and its color is RAL7035. The color of decoration strips is RAL5018. Two textures are available. The color of laminated plate is identical with that of cabinet body
防护等级 Protection grade	IP54 (按GB4205-1993) IP54 (in accordance with GB4205-1993)
标准配置 Standard configuration	柜体、后门板、前上玻璃门、前下钢板门、键盘抽屉、密封条、层板、门锁、脚轮(可选) Cabinet body, back door plate, front upper glass door, front lower steel door, keyboard drawer, sealing strips, laminated plate, door lock and casters (optional)
钢板厚度 Plate thickness	装饰条：铝合金 门板：2.0mm 层板：2.0mm 框架：九折型材1.5mm Decoration strip: aluminum alloy Door plate: 2.0mm Laminated plate: 2.0mm Frame: nine-fold section 1.5mm



抽出式鼠标垫  
Draw-out mouse pad



键盘抽屉  
Keyboard drawer



层板  
Laminated plate

## 产品特点 Features of product

- RAL7035的主体配合RAL5018的装饰条彰显柜体高端品质
- 监视区配有无反射安全玻璃确保安全可靠
- 九折型材的框架确保内部安装的灵活便利
- 前下柜门配用豪华摇把锁，检修门配用标准平面锁，搭配合理体现柜体设计人性化
- 极具人性化设计的键盘鼠标系统彰显柜体品质
- Main body in RAL7035 fitted with decoration strips in RAL5018 presents high-end quality of cabinet body
- Surveillance area is equipped with non-reflect safety glass to ensure safety and reliability
- Frame made of nine-fold section ensures flexibility and convenience of internal installation
- The front lower door is arranged with a luxury handle lock and the access door arranged with a standard flat lock, reasonably embodying humanized design of cabinet body.
- Humanized design of keyboard and mouse system reveals high quality of cabinet body

## PC系列订货规格表

### PC series order specification table

\*可定制非标产品  
Nonstandard products are customizable

序号 No.	订货号(RAL7032) Order number (RAL7032)	订货号(RAL7035) Order number (RAL7035)	宽 Width	高 Height	深 Depth
1	PC608040002	PC608040005	600	800	400
2	PC608050002	PC608050005	600	800	500
3	PC608060002	PC608060005	600	800	600
4	PC601050002	PC601050005	600	1000	500
5	PC601060002	PC601060005	600	1000	600
6	PC601070002	PC601070005	600	1000	700
7	PC601080002	PC601080005	600	1000	800
8	PC601260002	PC601260005	600	1200	600
9	PC601270002	PC601270005	600	1200	700
10	PC601280002	PC601280005	600	1200	800
11	PC801260002	PC801260005	800	1200	600
12	PC601460002	PC601460005	600	1400	600
13	PC601470002	PC601470005	600	1400	700
14	PC601480002	PC601480005	600	1400	800
15	PC801460002	PC801460005	800	1400	600
16	PC601660002	PC601660005	600	1600	600
17	PC601680002	PC601680005	600	1600	800
18	PC801660002	PC801660005	800	1600	600
19	PC801680002	PC801680005	800	1600	800
20	PC801860002	PC801860005	600	1800	600
21	PC601880002	PC601880005	600	1800	800
22	PC801860002	PC801860005	800	1800	600
23	PC801880002	PC801880005	800	1800	800
24	PC602060002	PC602060005	600	2000	600
25	PC602080002	PC602080005	600	2000	800
26	PC802060002	PC802060005	800	2000	600
27	PC802080002	PC802080005	800	2000	800
28	PC602260002	PC602260005	600	2200	600
29	PC602280002	PC602280005	600	2200	800
30	PC802260002	PC802260005	800	2200	600
31	PC802280002	PC802280005	800	2200	800

## RB工控柜系列

RB industrial control cabinet series



材料 Material	冷轧钢板、铝合金型材 Cold-roll steel sheets and aluminum alloy sections
表面处理 Surface treatment	机柜磷化底涂处理，外部为粉末涂层，颜色RAL7035，框架RAL5018，织纹，层板与柜同色 Cabinet is applied with etch primer and covered with powder coating on the outer side, and color is RAL7035. Frame is in RAL5018 color texture. The color of laminated plate is identical with that of cabinet body.
防护等级 Protection grade	IP54 (按GB4205-1993) IP54 (in accordance with GB4205-1993)
标准配置 Standard configuration	框架、玻璃前门、带通风槽的后门、19英寸(482.6mm)机架(立柱4根)、侧板、脚轮(可选)、层板(可选) Frame, front glass door, back door with ventilating slot, 19 inch (482.6mm) frame (with 4 upright columns), side plate, casters (optional) and laminated plate (optional)
钢板厚度 Plate thickness	框架：铝合金型材 门板：2.0mm 玻璃：5mm 钢化安全玻璃 侧板：1.5mm 立柱：铝合金型材 Frame: aluminum alloy section Door plate: 2.0mm Glass: 5mm toughened safety glass Back plate: 1.5mm Upright column: aluminum alloy section



活动层板  
Movable laminated plate



加强方管/铝合金型材  
Reinforced square pipe/aluminum alloy section



豪华摇把锁系列  
Luxury crank lock series

## 产品特点 Features of product

- RAL5018颜色的铝合金框架配合RAL7035的柜体颜色极尽美观彰显机柜豪华品质
- 19英寸的机架配以品种繁多的附件、内部安装件可以满足不同用户的安装需求
- 可选的高性能脚轮系统满足客户在现场的灵活机动性
- 前玻璃门配用豪华摇把锁，后检修门配用标准平面锁，搭配合理体现柜体设计人性化
- The arrangement of aluminum alloy frame in RAL5018 color along with cabinet body in RAL7035 color embodies elegant and luxury character of cabinet
- The 19 inch frame capable of containing a wide variety of accessories and internal installation parts meets installation requirements by various customers.
- Optional high performance caster system meets demands of customers for mobility on the site
- The front glass door is arranged with a luxury crank lock and the back access door arranged with a standard flat lock, reasonably embodying humanized design of cabinet body.

## RB系列订货规格表 Specifications RB luxury control cabinet series

\*可定制非标产品  
Nonstandard products are customizable

序号No.	订货号(RAL7035) Order number (RAL7035)	宽 Width	高 Height	深 Depth
1	RB608040005	600	800	400
2	RB608050005	600	800	500
3	RB608060005	600	800	600
4	RB601050005	600	1000	500
5	RB601060005	600	1000	600
6	RB601070005	600	1000	700
7	RB601080005	600	1000	800
8	RB601260005	600	1200	600
9	RB601270005	600	1200	700
10	RB601280005	600	1200	800
11	RB801260005	800	1200	600
12	RB601460005	600	1400	600
13	RB601470005	600	1400	700
14	RB601480005	600	1400	800
15	RB801460005	800	1400	600
16	RB601660005	600	1600	600
17	RB601680005	600	1600	800
18	RB801660005	800	1600	600
19	RB801680005	800	1600	800
20	RB601860005	600	1800	600
21	RB601880005	600	1800	800
22	RB801860005	800	1800	600
23	RB801880005	800	1800	800
24	RB602060005	600	2000	600
25	RB602080005	600	2000	800
26	RB802060005	800	2000	600
27	RB802080005	800	2000	800
28	RB602260005	600	2200	600
29	RB602280005	600	2200	800
30	RB802260005	800	2200	600
31	RB802280005	800	2200	800

# PA 斜面操作台系列

PA beveled operation console series



材料 Material	冷轧钢板 Cold rolled steel sheet
表面处理 Surface treatment	台体磷化底涂处理, 外部为粉末涂层, 颜色可分RAL7032和RAL7035两种两种织纹, 安装板则为镀锌 Cabinet is applied with etch primer and covered with powder coating on the outer side. Two color textures, RAL7032 and RAL7035, are available. The mounting plate is galvanized.
防护等级 Protection grade	IP54(按GB4205-1993) IP54 (In accordance with GB4205-1993)
标准配置 Standard configuration	前单(双)门、操作台面、柜体、安装板、门锁、密封条、液压支撑 Front single (dual) door, operating console board, cabinet body, mounting plate, door lock, sealing strips and hydraulic support
钢板厚度 Thickness of steel sheet	箱体: 2.0mm 门板: 2.0mm 操作台面: 2.0mm 安装板: 2.5mm Cabinet body: 2.0mm Door plate: 2.0mm Operation console board: 2.0mm Mounting plate: 2.5mm



液压支撑  
Hydraulic support



安装板  
Mounting plate

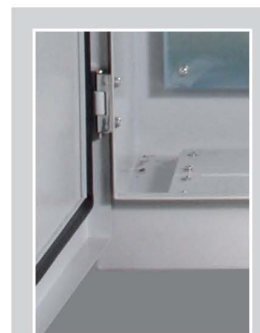

PU发泡密封条/三段式进线板  
PU foaming sealing strip/three-section cable entry plate



# PA 三段式操作台系列

## PA three-section operation console series



材料 Material	冷轧钢板 Cold rolled steel sheet
表面处理 Surface treatment	台体磷化底涂处理，外部为粉末涂层，颜色可分RAL7032和RAL7035两种两种织纹，安装板则为镀锌 Cabinet is applied with etch primer and covered with powder coating on the outer side. Two color textures, RAL7032 and RAL7035, are available. The mounting plate is galvanized.
防护等级 Protection grade	IP54(按GB4205-1993) IP54 (in accordance with GB4205-1993)
标准配置 Standard configuration	前单(双)门、操作台面、柜体、安装板、门锁、密封条、液压支撑 Front single (dual) door, operating console board, cabinet body, mounting plate, door lock, sealing strips and hydraulic support
钢板厚度 Thickness of steel sheet	箱体: 2.0mm 门板: 2.0mm 操作台面: 2.0mm 安装板: 2.5mm Cabinet body: 2.0mm Door plate: 2.0mm Operation console board: 2.0mm Mounting plate: 2.5mm



水平台面液压支撑  
Hydraulic support for horizontal table board



上台面拉杆支撑  
Draw bar support of upper table board



水平台面锁系统  
Lock system of upper table board



上台面锁系统  
Lock system of upper table board



PU发泡密封条  
PU foaming sealing strip



上台体安装板  
Mounting plate of upper table board

## 产品特点 Features of products

- 独特的外形结构设计彰显台体的豪华品质
- 三段式台体均可拆卸并可独立使用
- A、B操作面板，后显示器盖板，前后单(双)门均可打开并配以豪华液压支撑以及高强度拉杆的使用体现了台体的人性化设计及安装的便利性
- 前后单(双)门离地很高约为25mm，确保开门的顺畅和便利
- 具体三段台体结构尺寸详见图纸
- Unique appearance and structure design embodies luxury character of console body.
- The three sections of console body are dismantlable and can be used independently.
- A and B operating panels, back display cover plate and front and back single (dual) doors can be opened and fixed with luxury hydraulic supports and high-strength draw bars, embodying humanized design and installation convenience.
- Ground clearance of front and back single (dual) doors is sufficient, about 25mm, ensuring smoothness and convenience of door opening.
- Specific three-section console structural dimension is detailed in drawing.

## PA 系列订货规格表 PA series order specification table

\*可定制非标产品  
Nonstandard products are customizable

序号 No.	订货号 (RAL7032) Order number (RAL7032)	订货号 (RAL7035) Order number (RAL7035)	宽 Width	高 Height	深 Depth
1	PA 80135002	PA 80135005	800	1300	500
2	PA 10135002	PA 10135005	1000	1300	500
3	PA 12135002	PA 12135005	1200	1300	500
4	PA 16135002	PA 16135005	1600	1300	500
5	PA 80155002	PA 80155005	800	1500	500
6	PA 10155002	PA 10155005	1000	1500	500
7	PA 12155002	PA 12155005	1200	1500	500
8	PA 16155002	PA 16155005	1600	1500	500
9	PA 80134002	PA 80134005	800	1300	400
10	PA 10134002	PA 10134005	1000	1300	400
11	PA 12134002	PA 12134005	1200	1300	400
12	PA 16134002	PA 16134005	1600	1300	400
13	PA 80154002	PA 80154005	800	1500	400
14	PA 10154002	PA 10154005	1000	1500	400
15	PA 12154002	PA 12154005	1200	1500	400
16	PA 16154002	PA 16154005	1600	1500	400

# 机箱机柜附件系列

## stand-alone control cabinet series

### HFM控制箱柜钥匙

#### HFM control box key

订货号 Order No. KP004



### 防雨锁 HFM830

#### Rain lock HFM830

订货号 Order No. HFM830



### 小锁 HFM813

#### Small lock HFM813

订货号 Order No. HFM813



### 不锈钢小锁 HFM814

#### Small stainless steel lock HFM814

订货号 Order No. HFM814



### 新型AE01壁挂件

#### New AE01 wall mounting parts

订货号 Order No. AE01



### 新型AE02壁挂件

#### New AE02 wall mounting parts

订货号 Order No. AE02

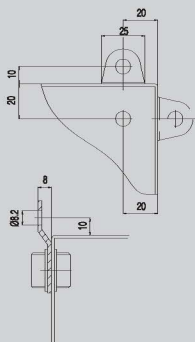

**AE01 墙壁挂件 / AE01 wall mounting parts**  
用于固定KL、EB和GB箱体。  
Used for fixed KL, EB and GB box.  
供应范围 / Supply range:  
包括用于安装在箱体上的安装固定件。  
Including the fixing parts on boxes.  
出于防护等级和卫生的原因，不锈钢箱体没有预埋固定件用的钻孔。  
For the sake of protection class and health reasons, there are no drilling holes for the wall fixing parts on the stainless steel box.

备注 / Remarks:

材料 / Material	离端壁的距离 Distance from wall (mm)	每包 Each pack
钢板镀锌，铬酸钝化 Galvanized steel sheet, chromate passivation	8	4个 / pcs

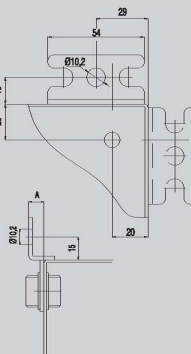

#### AE02 墙壁挂件 / AE02 wall mounting parts

用于固定KL、EB和GB箱体。  
Used for fixed KL, EB and GB box.  
供应范围 / Supply range:  
包括用于安装在箱体上的安装固定件。  
Including the fixing parts on boxes.

备注 / Remarks:  
出于防护等级和卫生的原因，  
不锈钢箱体没有预埋固定件用的钻孔。  
For the sake of protection class and health reasons,  
there are no drilling holes for the wall fixing parts  
on the stainless steel.

材料 / Material	离端壁的距离 Distance from wall	每包 Each pack
钢板镀锌，铬酸钝化 Galvanized steel sheet, chromate passivation	10	4个 / pcs
不锈钢 4301 Stainless steel 1.4301	10	4个 / pcs

1) 不带安装固定件 / Without fixing parts

**AE 门限位器**  
AE door restrictors

订货号 Order No. XWQ-GB



**PS 门限位器**  
PS door restrictors

订货号 Order No. XWQ-KP



**取代吊环螺栓**  
Replace the lift ring bolts

订货号 Order No. DH-001



**接触垫圈**  
Contact washer

订货号 Order No. JCDQ-M5 / JCDQ-M6 / JCDQ-M8



**脚轮**  
Casters

订货号 Order No. PS001



**可调支脚**  
Adjustable feet

订货号 Order No. PS002



**表面修补油漆**  
Surface make-up paint

订货号 Order No. PG-7035 / PG-7032



**不锈钢光亮剂**  
Stainless steel brightener

订货号 Order No. GLJ001



## 门托架 Door bracket

订货号 Order No.	KP005
---------------	-------



## AE门板走线条 AE door plate lines

序号 Item No.	订货号 Order No.	箱门宽度 Width of box door (mm)	材料 Material	厚度 Thickness (mm)	备注 Remarks
1	AE ZXT200	200	镀锌钢板 Galvanized steel sheet	1.5	2根/包 2 pcs/pack
2	AE ZXT300	300	镀锌钢板 Galvanized steel sheet	1.5	2根/包 2 pcs/pack
3	AE ZXT380	380	镀锌钢板 Galvanized steel sheet	1.5	2根/包 2 pcs/pack
4	AE ZXT400	400	镀锌钢板 Galvanized steel sheet	1.5	2根/包 2 pcs/pack
5	AE ZXT500	500	镀锌钢板 Galvanized steel sheet	1.5	2根/包 2 pcs/pack
6	AE ZXT600	600	镀锌钢板 Galvanized steel sheet	1.5	2根/包 2 pcs/pack
7	AE ZXT800	800	镀锌钢板 Galvanized steel sheet	1.5	2根/包 2 pcs/pack
8	AE ZXT1000	1000	镀锌钢板 Galvanized steel sheet	1.5	2根/包 2 pcs/pack



## PS并柜件 PS combined cabinet parts

序号 Item No.	订货号 Order No.	备注 Remarks
1	PS J01	2件/包 / 2 pcs/pack
2	PS J02	4件/包 / 4 pcs/pack
3	PS J03	6件/包 / 6 pcs/pack
4	PS J04	10米/包 / 10 pcs/pack

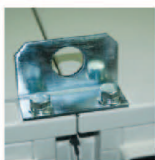

PS J01



PS J02



PS J03



PS J04

## 托架式台面 Bracket-style table

序号 Item No.	图号 Drawing No.	宽度 Width mm	深度 Depth mm	适用于门宽度 Applicable to door width (mm)	材料 Material	颜色 Color
1	TM600	413	400	600	冷轧钢板 Cold-rolled steel sheet	RAL 7035
2	TM800	613	400	800	冷轧钢板 Cold-rolled steel sheet	RAL 7035



## PS门板走线条 PS door plate lines

序号 Item No.	订货号 Order No.	箱门宽度 Width of box door (mm)	材料 Material	厚度 Thickness (mm)	备注 Remarks
1	PSZXT600	600	镀锌钢板 Galvanized steel sheet	1.5	2根/包 2 pcs/pack
2	PSZXT800	800	镀锌钢板 Galvanized steel sheet	1.5	2根/包 2 pcs/pack
3	PSZXT1000	1000	镀锌钢板 Galvanized steel sheet	1.5	2根/包 2 pcs/pack
4	PSZXT1200	1200	镀锌钢板 Galvanized steel sheet	1.5	2根/包 2 pcs/pack





## 产品案例



上海电气  
上海大学  
北京火车站调度所  
虹桥火车站  
宁波会展中心  
杭州地铁1号线  
邯郸文化广场  
宝钢股份有限公司  
上海银行  
广州西塔国金中心  
海珠区老干部公寓  
广西中烟公司  
铁道部  
北京地铁10号线

上海地铁13号线  
东营商业银行  
长兴电力调度大楼  
七堡车辆段  
梅州卷烟厂动力中心  
深圳档案馆  
厦门隧道  
天津东站调度中心  
狮子洋隧道  
福建档案馆  
武汉铁路调度所  
上海铁路调度所  
天津东站35KV变电所  
佛山烟草公司

www.rongbeish.com

北

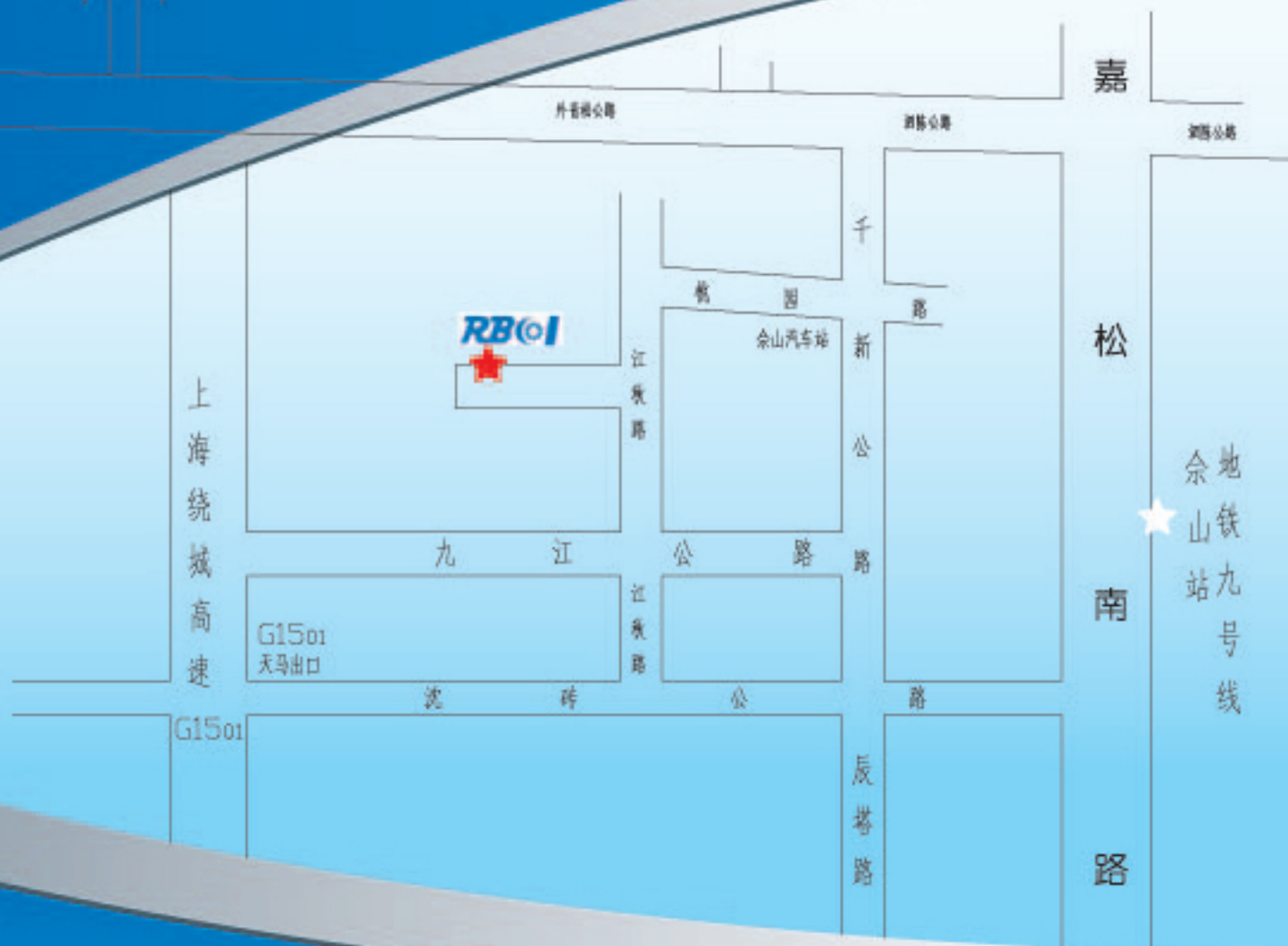

## 上海容贝实业有限公司

地址：上海市松江区佘山镇江秋路2号

电话：+86 021 37010107

传真：+86 021 37010108

网址：www.rongbeish.com